

*Here 's a chance to pay €0 for electricity bill .*

# Why Not ?

Just add the SolaX Power **X3-Fit** to your existing or new build solar system, you're one more step closer to energy independence.



X3-Fit 8.0kW  
X3-Fit 10.0kW

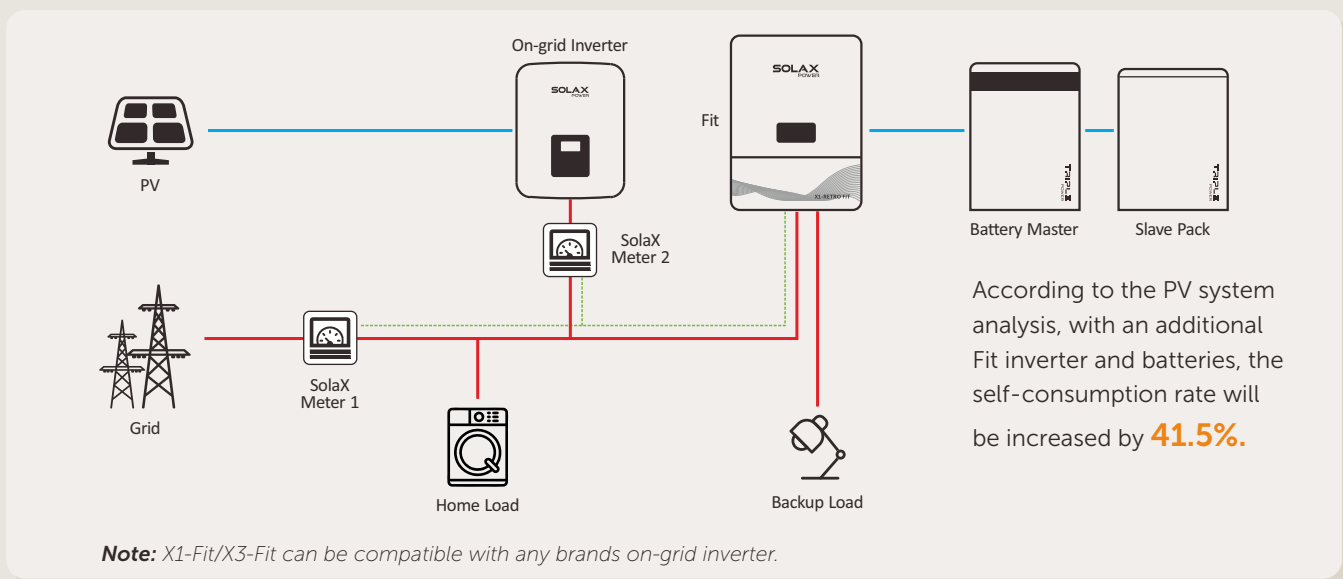

According to the PV system analysis, with an additional Fit inverter and batteries, the self-consumption rate will be increased by **41.5%**.

*Note: X1-Fit/X3-Fit can be compatible with any brands on-grid inverter.*



www.solaxpower.com  
info@solaxpower.com  
service@solaxpower.com

Global: +86 571-56260008  
AU: +61 1300 476529  
DE: +49 6142 4091664

UK: +44 2476 586998  
NL: +31 (0) 852 737932



# X3-RETRO FIT (THREE PHASE)

Version: E,C  
 E:with EPS function  
 C:without EPS function

## X3-Fit-8.0

## X3-Fit-10.0

	X3-Fit-8.0		X3-Fit-10.0	
	E Version	C Version	E Version	C Version
<b>OUTPUT (AC)</b>				
Nominal AC power [VA]	8000	8000	10000	10000
Max. apparent AC power [VA]	8000	8000	10000	10000
Nominal grid voltage(AC voltage range) [V]	400V/230VAC;380/220VAC			
Nominal grid frequency/range [Hz]	50/60			
Nominal AC current [A]	11.6	11.6	14.5	14.5
Max. AC current [A]	12.8	12.8	16.0	16.0
Displacement power factor	0.8 leading to 0.8 lagging			
THDi, rated power [%]	<3			
<b>INPUT AC</b>				
Max. apparent AC power[VA]	8000	8000	10000	10000
Max. AC current[A]	12.8	12.8	16.0	16.0
Nominal grid voltage(AC voltage range)[V]	400/230;380/220			
Nominal grid Frequency/range[Hz]	50/60			
<b>OUTPUT DC (BATTERY)</b>				
Battery voltage range [V]	160-800			
Max.continuous charge/discharge current [A]	35(0.5H)			
Communication interfaces	CAN/ RS485			
Reverse connect protection	YES			
<b>EPS OUTPUT(WITH BATTERY)</b>				
EPS MAX. continuous apparent power [VA]	8000	-	10000	-
EPS rated voltage[VAC],Frequency [Hz]	400/230;380/220 50/60	-	400/230;380/220 50/60	-
EPS MAX.continuous current [A]	11.6	-	14.5	-
EPS peak apparent power [VA] Duration [s]	10000 60	-	10000 60	-
Changeover time [s]	<1.5	-	<1.5	-
THDv, linear Load [%]	<2	-	<2	-
Changeover device	external	-	external	-
Three phases unbalanced	YES			
<b>EFFICIENCY</b>				
Max. Battery charge efficiency (GRID to BAT)	96.0			
Max. Battery discharge efficiency (BAT to AC)	96.5			
<b>POWER CONSUMPTION</b>				
Standby consumption (Night) [W]	<25 for hot standby, <3 for cold standby			
<b>SAFETY&amp; PROTECTION</b>				
Over/under voltage protection	Yes			
Monitoring ground fault protection	Yes			
Grid protection	Yes			
<b>STANDARD</b>				
Safety	IEC62477			
EMC	EN 61000-6-1 / EN 61000-6-2 / EN 61000-6-3			
Certification	VDE 0126-1-1 A1:2012 / VDE-AR-N 4105 / G98 / AS4777 / EN50549/ CEI 0-21			
<b>ENVIRONMENT LIMIT</b>				
Degree of protection(according to IEC60529)	IP65			
Operating temperature range [°C]	-20 ~ +60 (derating at +45)			
Max. operation altitude [m]	<2000			
Humidity [%]	0~100 (condensing)			
Storage temperature [°C]	-20 ~ +60			
Typical noise emission [dB]	40			
<b>DIMENSION AND WEIGHT</b>				
Dimensions(WxHxD) [mm]	457*654*228			
Weight [kg]	38			
Cooling concept	Natural			
Topology	Non-isolated			
Communication interfaces	Ethernet/Meter/Pocket WiFi(optional)/Pocket LAN(optional)/Pocket GPRS(optional)/DRM/USB/ISO alarm/CAN/BMS/NTC			
LCD display	Backlight 20*4 character			
Standard warranty [year]	5-10			